

FREEMAN

1701 Lebanon Pike Circle
Nashville, TN 37210
(615) 884-5785 • Fax: (469) 621-5615
FreemanNashvilleES@freemanco.com



**DISCOUNT PRICE
DEADLINE DATE
APRIL 12, 2013**

**INCLUDE THE FREEMAN METHOD OF
PAYMENT FORM WITH YOUR ORDER**

NAME OF SHOW: **WEF - RESIDUALS & BIOSOLIDS AND ENERGY & WATER CONFERENCE / MAY 06 - 08, 2013**

COMPANY NAME: _____ BOOTH #: _____

CONTACT NAME: _____ PHONE #: _____

E-MAIL ADDRESS: _____

For Assistance, please call (615) 884-5785 to speak with one of our experts.

For fast, easy ordering, go to www.freemanco.com/store

SHOWCASES

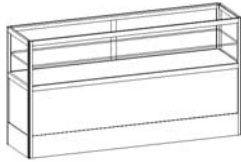

HALF VISION SHOWCASE

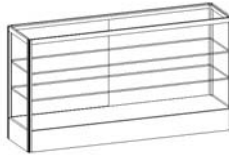

FULL VISION SHOWCASE

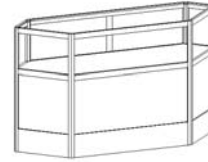

CORNER SHOWCASE

Qty	Part #	Description	Online Special	Discount Price	Standard Price	Total
PERFBOARD / BULLETIN BOARDS						
_____	17551202	Full Vision Case 1M x 1/2M.....	\$405.45	446.00	567.65	_____
_____	17551203	Full Vision Case 2M x 1/2M.....	\$605.60	666.15	847.85	_____
_____	17551206	Half Vision Case 1M x 1/2M.....	\$405.45	446.00	567.65	_____
_____	17551207	Half Vision Case 2M x 1/2M.....	\$605.60	666.15	847.85	_____
_____	175563	Corner Case.....	\$605.60	666.15	847.85	_____

FULL VISION CASE Includes two plexi-glass shelves with adjustable brackets and 32³/₈" of viewing area. No storage below display area.

HALF VISION CASE Includes one plexi-glass shelf with adjustable brackets and 14¹/₂" of viewing area.

CORNER SHOW CASE Includes an area for storage below the display surface and has 12¹/₄" of viewing area.

All showcases are 42" high and include a lightbar mounted inside the top front edge and a sliding door with lock on the back.

Electrical service for lightbar must be arranged through the facility.

TOTAL COST		
Sub-Total _____	+ Tax (9.25%) _____	= TOTAL _____

FREEMAN showcases

Take advantage of the Online Special price by ordering online at www.freemanco.com/store by **APRIL 12, 2013**

Don't see what you need?
Please call an Exhibitor Services Representative @ (615) 884-5785.